



Catalog Number 12096
UPC Number 60198612096
Description Nylon Insulated Female Receptacle
 Bullet Disconnect
 12-10 AWG .193 OD



Features

- Nylon Color Coded insulation for easy identification
- Manufactured from high strength copper alloy
- Electro-tin plated for corrosion resistance
- Expanded insulation eliminates strand “Hang Up”, provides strain relief & excellent UV, temperature and chemical resistance
- Wire range stamped on the surface for easy interpretation
- Brazed seams prevent splitting under maximum pressure
- Serrated barrel & extended copper crimp sleeve provides excellent electrical contact & pull-out force resistance

General

Insulation Type Nylon
Material Brass/Copper
Finish Electro-Tin Plated
Color Yellow
Wire Range 10-Dec
Bullet Size 0.197

Dimension Information

T Inches (mm) 0.016
L Inches (mm) 1.063
B Inches (mm) 0.433
C Inches (mm) 0.134
D Inches (mm) 0.197
F Inches (mm) 0.276
W Inches (mm) 0.193

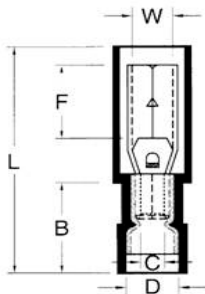

Specifications

Temperature Rating 105°C
Voltage Rating 600 V
Flammability Rating UL94V-O
Amp Rating 12 AWG 20 Amps
 10 AWG 24 Amps

Packaging

Bag Qty 100
Master Bag Qty 1000

Certifications

UL Yes
cUL Yes
RoHS Yes

Morris Products 53 Carey Road, Queensbury, NY 12804

www.morrisproducts.com

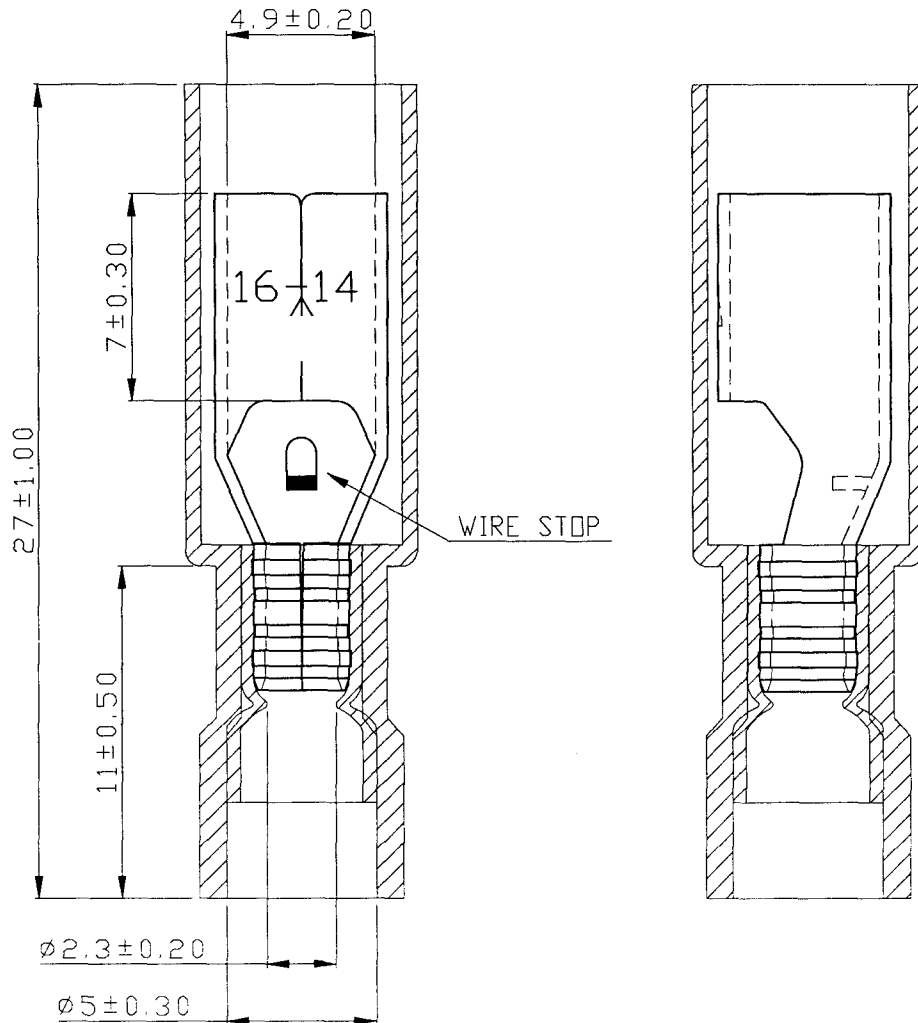
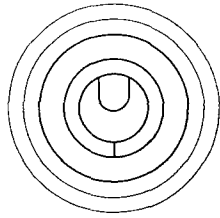

REV	DESCRIPTION	DATE
-----	-------------	------

NOTE:

- MAXIMUM ELECTRIC CURRENT :

A.W.G.	16	14	
AMP.	10	15	
- MAXIMUM ELECTRICAL RATING : 105°C 600 VOLTS MAX.
- INSULATION MATERIAL : NYLON
- INSULATION COLOR : BLUE
- TERMINAL MATERIAL : BRASS
- WIRE RANGE : 16-14 A.W.G.(1.5-2.5 mm²)
- TERMINAL SURFACE TREATMENT : TIN PLATED
- DOUBLE CRIMP : WITH COPPER SLEEVE ON BARREL
- TERMINAL THICKNESS : 0.40 mm

Tolerance Unless Otherwise Specified	
0 > 6 mm ± 0.20	ANGLE
6 > 18 mm ± 0.30	0° > ° REF ±
18 > 30 mm ± 0.40	° > ° ±
30 > 75 mm ± 0.50	° > ° ±

NAME	NYLON-FULLY INSULATED DOUBLE CRIMP RECEPTACLE DISCONNECTORS			UNIT
PART NO.	12096	MATERIAL	-----	APPROVE
NUMBER		SCALE	SHEET PAGE	CHECKED
DATE	2006/12/27	4/1	1-0 10F2	DRAWN

Morris Products Inc.