

Non-Insulated Parallel Connectors

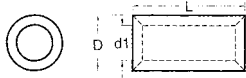
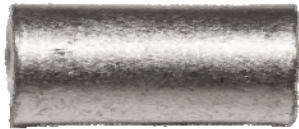

MAXIMUM ELECTRIC CURRENT:

Awg	22	20	18	16	14	12	10
Amp	9	12	17	18	30	35	50

MAXIMUM ELECTRIC RATING: 221°F(150°C) 600V

CONNECTOR MATERIAL: Electro-Tin Plated Tubular Copper

Dimensions = Inches

Cat. No.	Wire Size AWG	L	D	D1	Bag Qty	Master Bag Qty
12151	26-22	.197	.083	.051	100	1000
12152	22-16	.315	.130	.067	100	1000
12154	16-14	.315	.154	.091	100	1000
12156	12-10	.335	.213	.134	100	1000
12157	8	.374	.276	.181	100	-
12158	6	.433	.350	.232	100	-
12159	4	.531	.445	.307	100	-
12160	2	.650	.520	.374	100	-

Vinyl Insulated Parallel Connectors

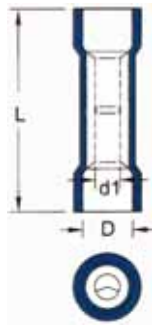

MAXIMUM ELECTRIC CURRENT:

Awg	22	20	18	16	14	12	10
Amp	9	12	17	18	30	35	50

MAXIMUM ELECTRIC RATING: 167°F (75°C) 600 Volts

CONNECTOR MATERIAL: Electro-Tin Plated Tubular Copper

INSULATION MATERIAL: Vinyl

FEATURES: Expanded Insulation

Dimensions = Inches

Cat. No.	Color	Wire Size AWG	L	D	d1	Bag Qty	Master Bag Qty
12162	Red	22-16	.650	.157	.067	100	1000
12164	Blue	16-14	.650	.177	.091	100	1000
12166	Yellow	12-10	.795	.248	.134	100	1000

Vinyl Insulated 3-Way & 4-Way Connectors

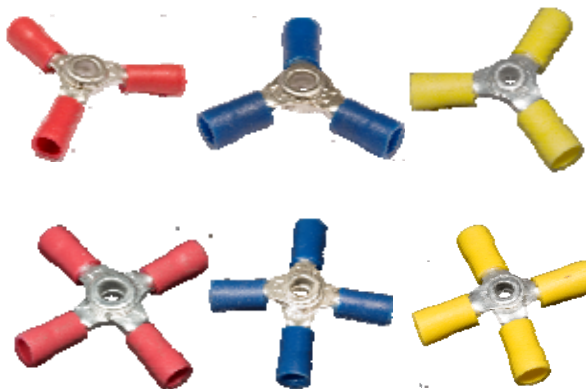

MAXIMUM ELECTRIC CURRENT:

Awg	22	20	18	16	14	12	10
Amp	9	12	17	18	30	35	50

MAXIMUM ELECTRIC RATING: 167°F (75°C) 600 Volts

INSULATION MATERIAL: Vinyl

CONNECTOR MATERIAL: Electro-Tin Plated Copper

FEATURES: Expanded Insulation

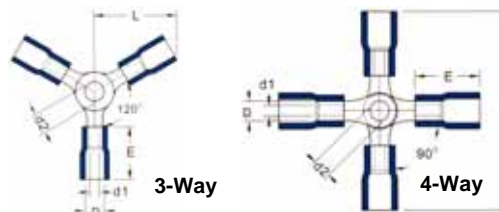

Dimensions = Inches

Cat. No.	Color	Wire Size AWG	Stud Size	d2	L	D	E	d1	Bag Qty	Master Bag Qty
12172	Red 3-Way	22-16	#8	.157	.669	.157	.394	.067	100	1000
12174	Blue 3-Way	16-14	#8	.157	.709	.177	.394	.091	100	1000
12176	Yellow 3-Way	12-10	#8	.157	.866	.248	.512	.134	100	1000
12178	Red 4-Way	22-16	#8	.157	1.339	.157	.394	.067	100	1000
12180	Blue 4-Way	16-14	#8	.157	1.398	.177	.394	.091	100	1000
12182	Yellow 4-Way	12-10	#8	.157	1.713	.248	.512	.134	100	1000